

Plan View

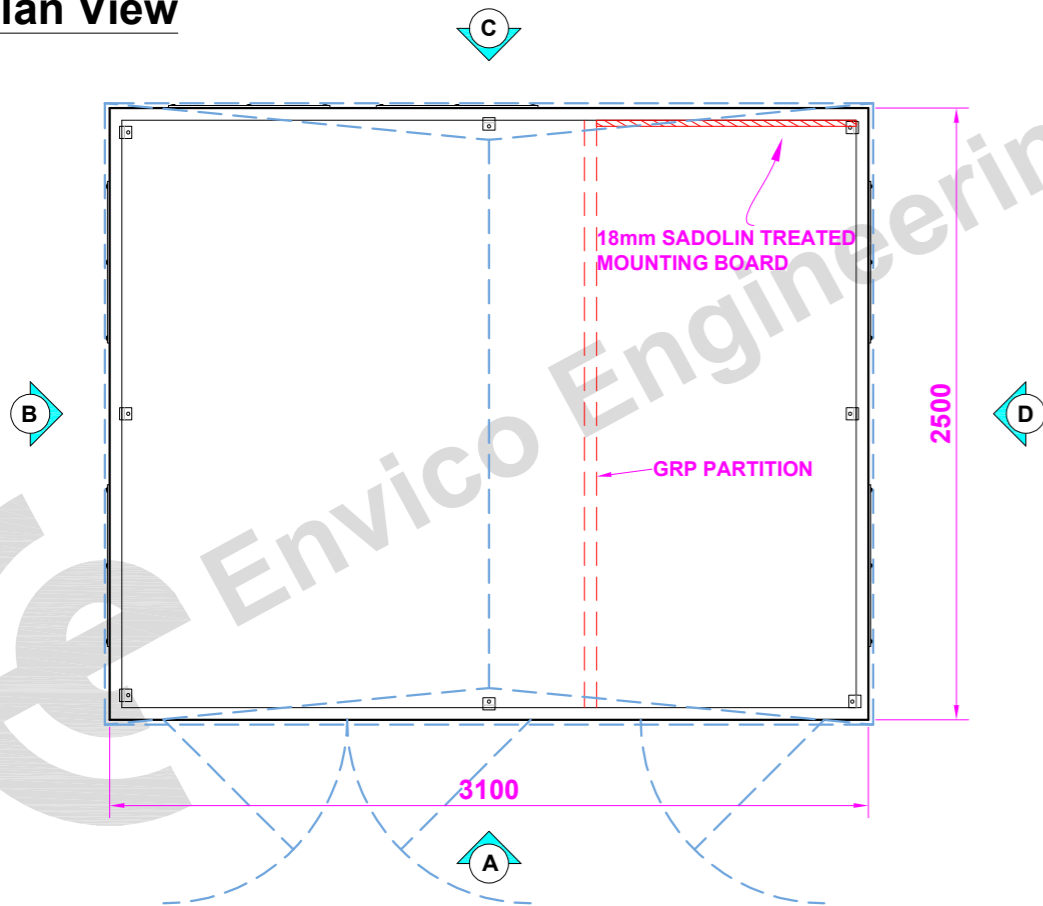

Elevation (A) (front)

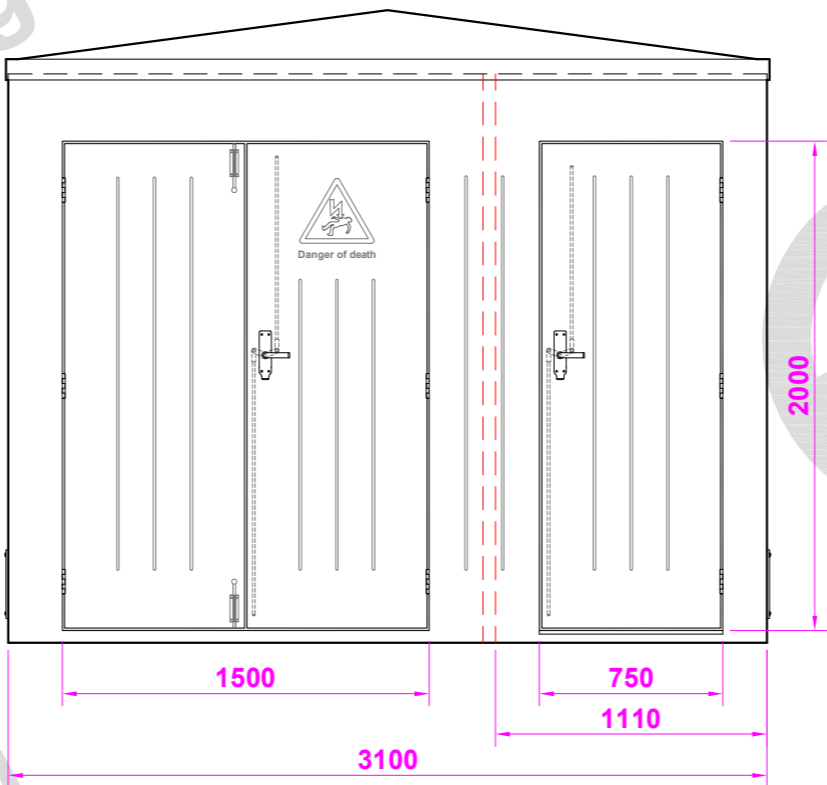

TYPICAL BASE DETAIL

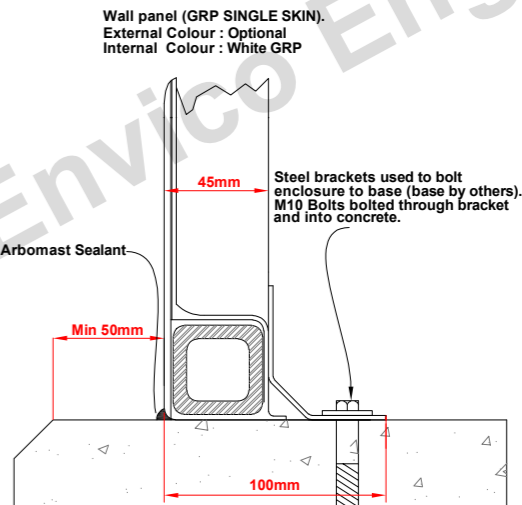

Elevation (B) (l/h side)

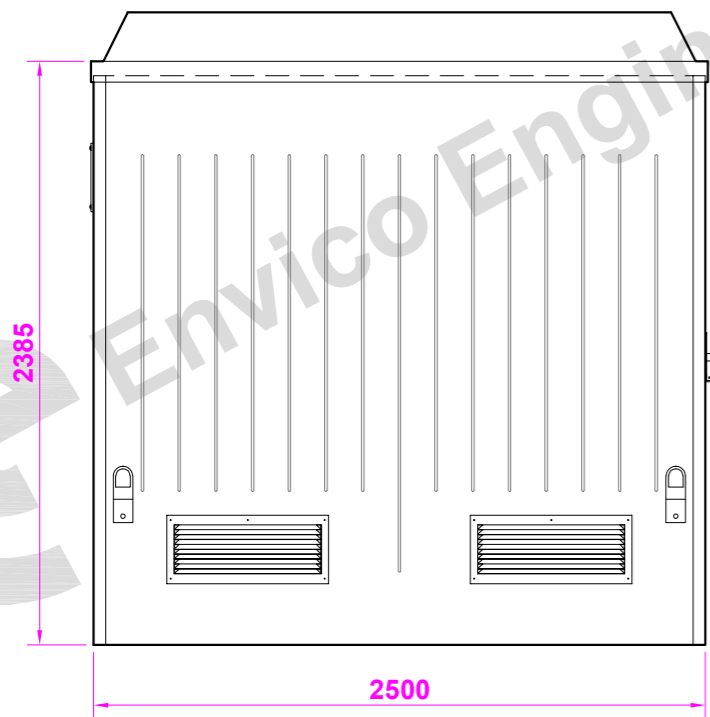

Elevation (C) (rear)

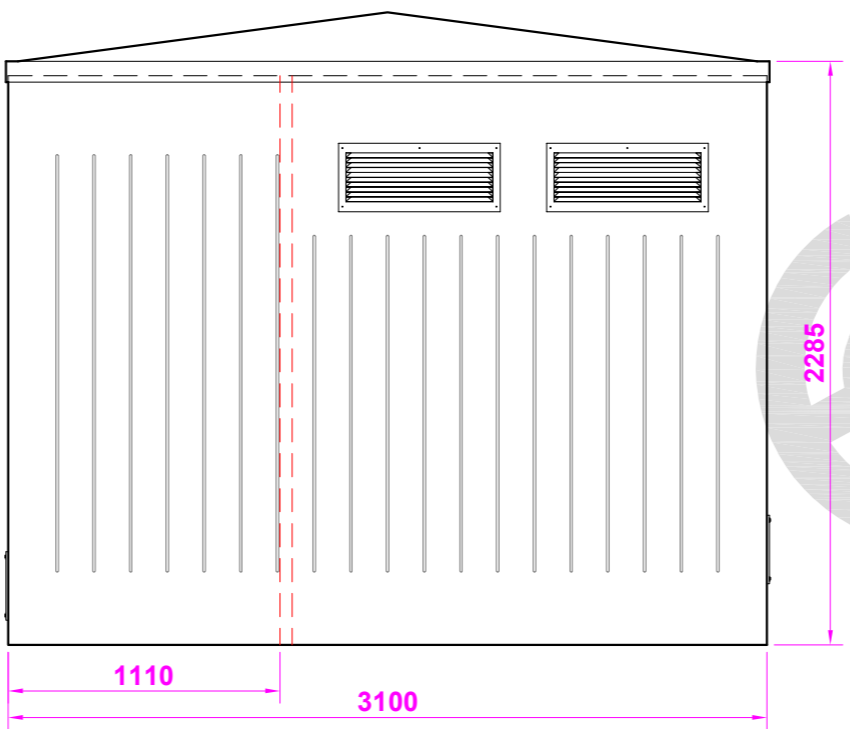

Elevation (D) (r/h side)

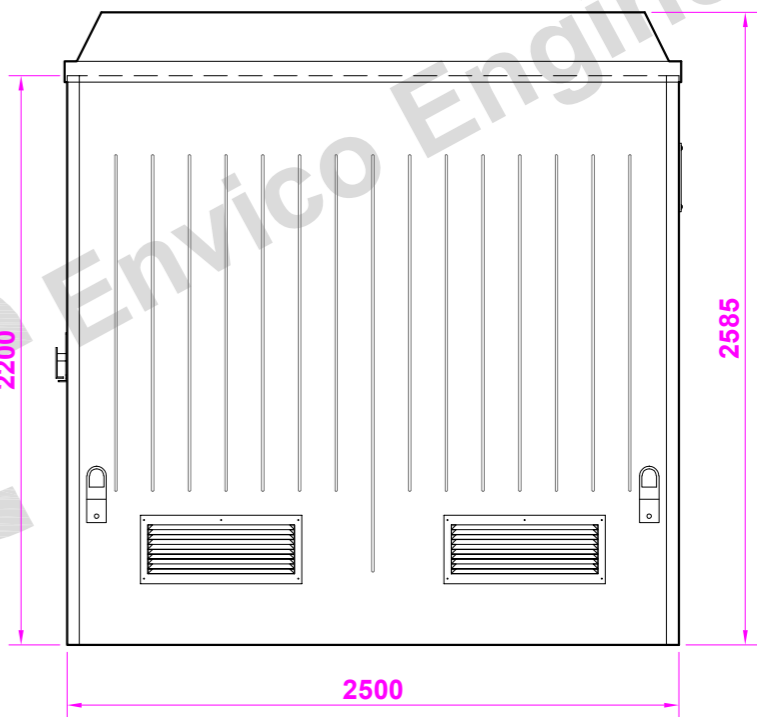

PARTS LIST

ITEM	QTY.	COMMENTS	ITEM	QTY.	COMMENTS
GRP DOUBLE DOOR	1	ELEVATION A 1500mm X 2000mm	GALV STEEL VENTS	6	ELEVATIONS B, C & D
GRP SINGLE DOOR	1	ELEVATION A 750mm X 2000mm	DANGER OF DEATH MOULD	1	ELEVATION A (IN DOORS)
STAINLESS STEEL DOOR HINGES	9	ELEVATIONS A (DOORS)	EXPLOSION RELIEF BRACKETS	4	
ST - STEEL ESPAGNOLETTE LATCH	2	ELEVATION A	ST - STEEL FIXING FEET	8	DRILLED FOR M10 X 100 BOLTS
ST-STEEL SPRING TOWER BOLTS	2	ELEVATION A	LIFTING EYES	4	ELEVATIONS B & D
10/10 DOOR STAYS	3	ELEVATION A	18mm SADOLIN TREATED MOUNTING BOARD	1	ON REAR WALL - SEE DRAWING
GRP PARTITION	1	SEE DRAWING			

CONSTRUCTION DETAILS

INTERNAL WIDTH : 2990mm  
INTERNAL DEPTH : 2390mm  
INTERNAL HEIGHT : 2300mm

EXTERNAL WIDTH : 3100mm  
EXTERNAL DEPTH : 2500mm  
EXTERNAL HEIGHT : 2585mm

G.R.P CONSTRUCTION

LAYER 1. GEL COAT, COLOURED.  
LAYER 2. 450GRM/M.SQ GLASS & RESIN  
LAYER 3. 450GRM/M.SQ GLASS & RESIN  
LAYER 4. 450GRM/M.SQ GLASS & RESIN  
ALL RESIN TO CLASS II FIRE RETARDANT GRADE.  
ALL REINFORCING BETWEEN LAYERS 3 & 4



**G.R.P HOUSING  
MODEL TR16**  
APPROX WEIGHT: 580kg



**Envico Engineering**

THE DRAWING AND DESIGN IS THE PROPERTY OF ENVICO ENGINEERING LTD. AND WITHOUT THE WRITTEN CONSENT OF ENVICO ENGINEERING LTD. MAY NOT BE COPIED IN WHOLE OR IN PART OR COMMUNICATED TO A THIRD PARTY OR USED FOR ANY PURPOSE.