

Plan View

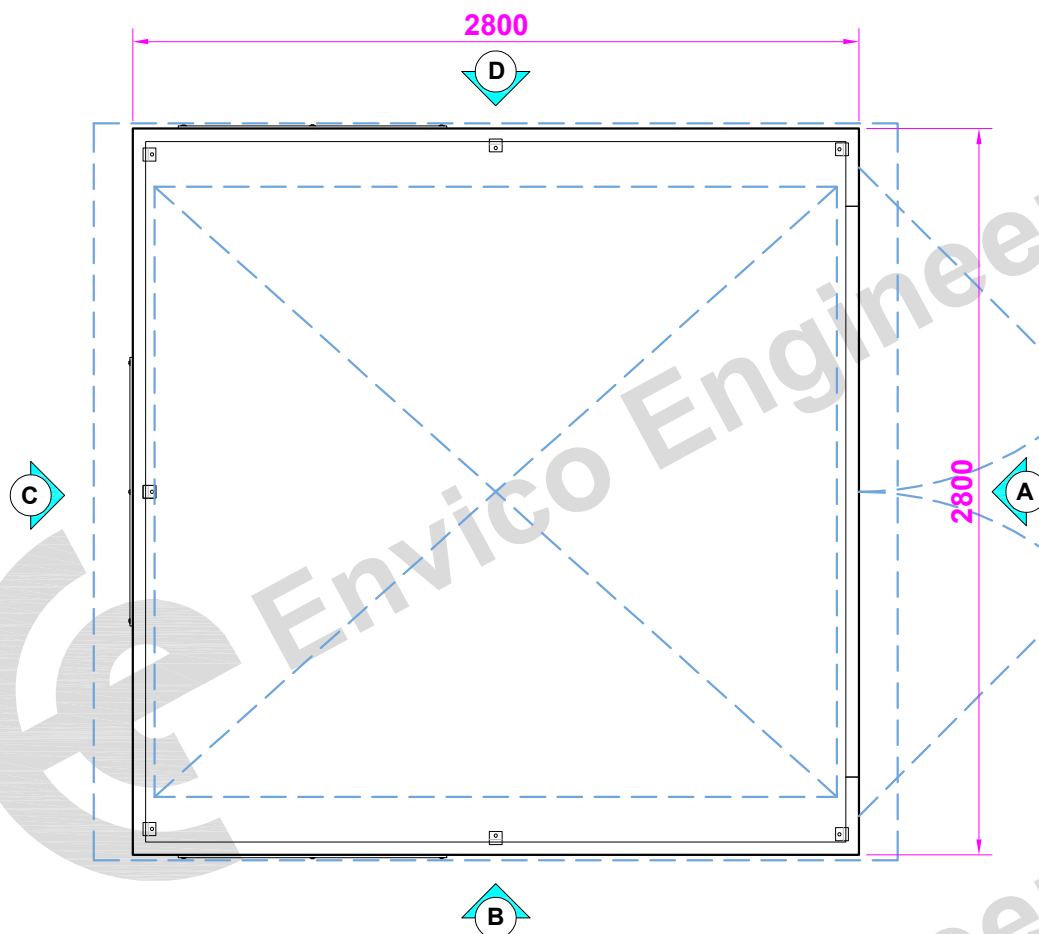

Elevation (A) (front)

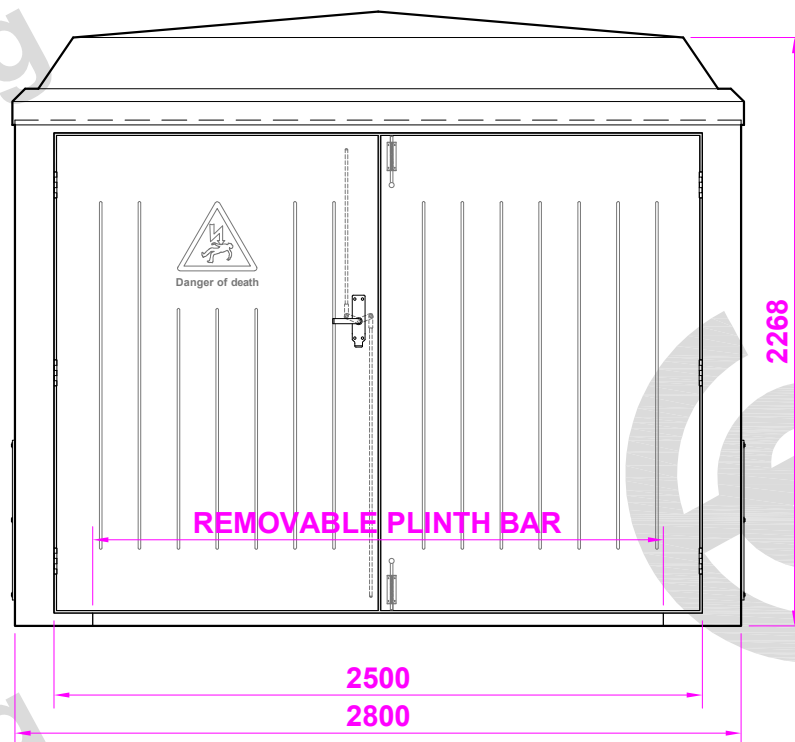

TYPICAL STEPPED BASE DETAIL (RECOMMENDED)

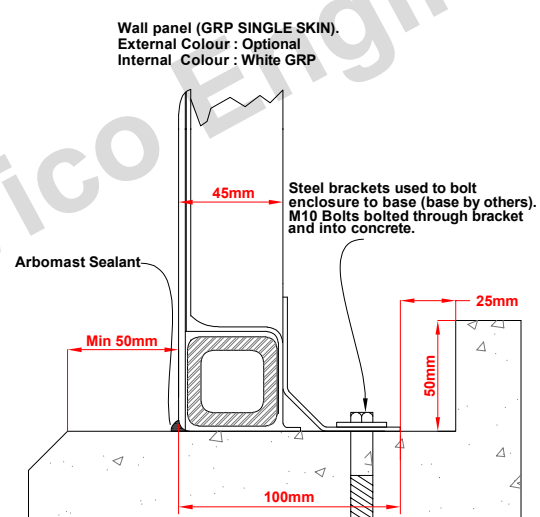

Elevation (B) (l/h side)

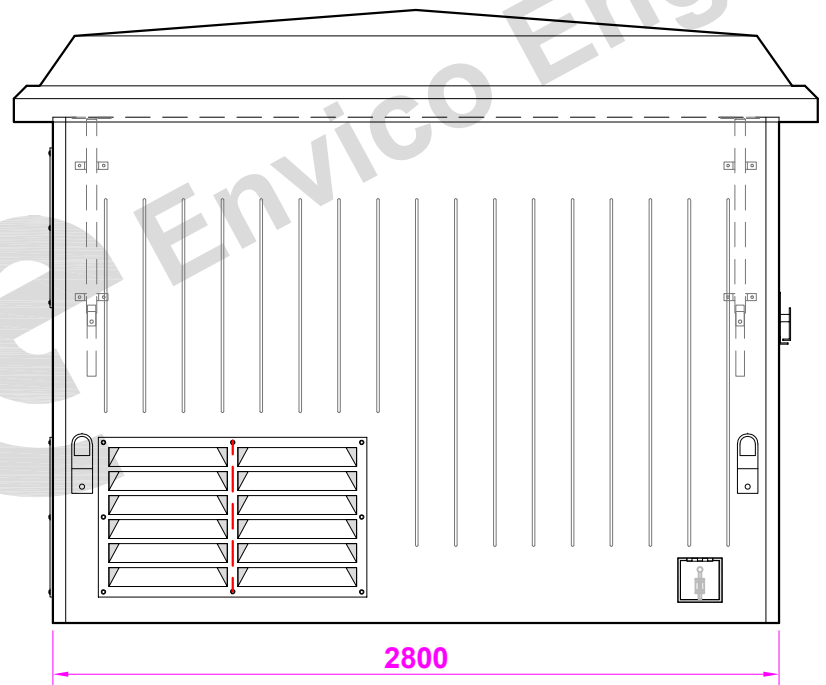

ROOF OVERHUNG AT FRONT AND REAR TO PROVIDE HIGH LEVEL VENTILATION

Elevation (C) (rear)

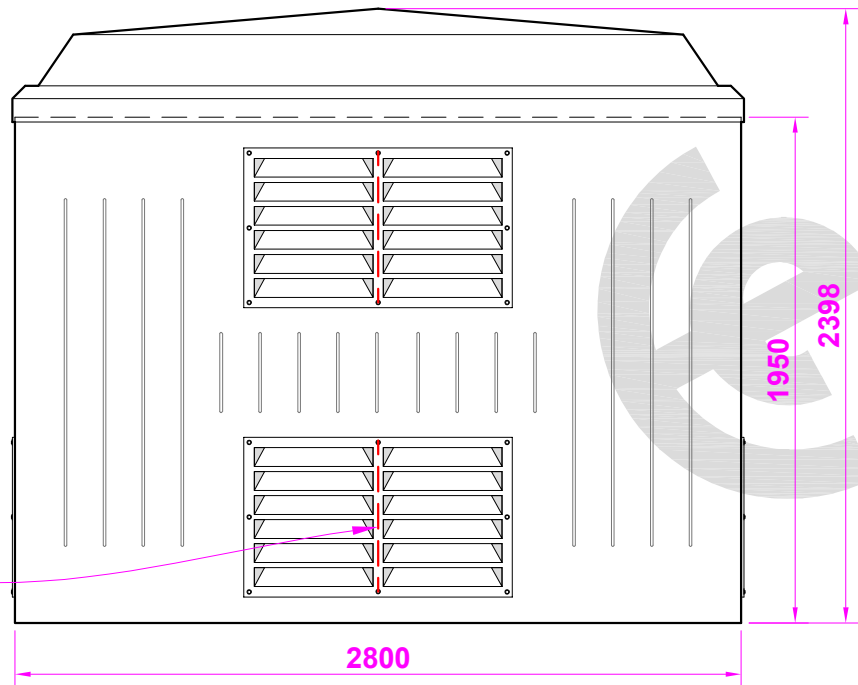

Elevation (D) (r/h side)

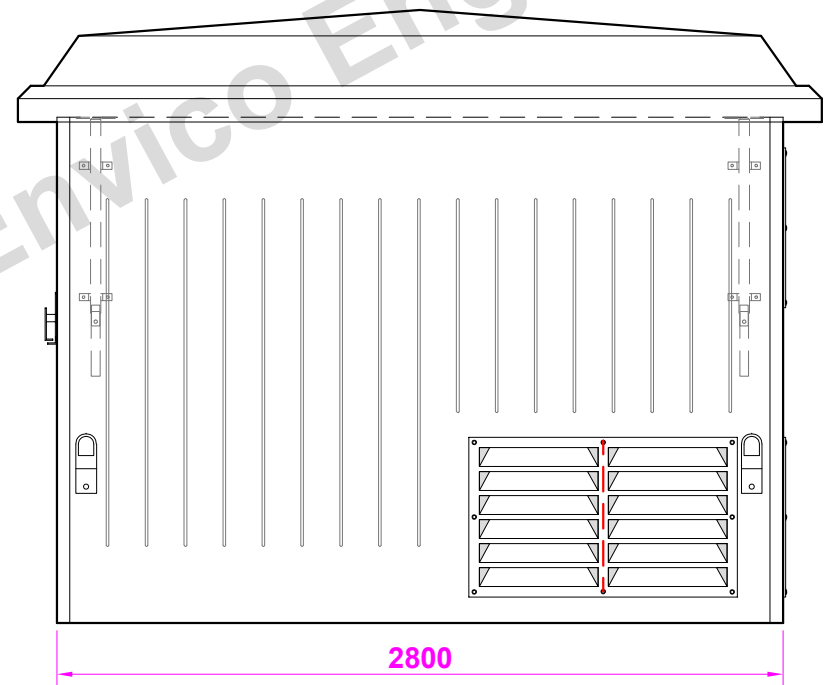

**G.R.P HOUSING  
MODEL TR7**  
APPROX WEIGHT: 480kg

CONSTRUCTION DETAILS

INTERNAL WIDTH : 2690mm  
INTERNAL DEPTH : 2690mm  
INTERNAL HEIGHT : 2250mm  
  
EXTERNAL WIDTH : 2800mm  
EXTERNAL DEPTH : 2800mm  
EXTERNAL HEIGHT : 2398mm

G.R.P CONSTRUCTION

LAYER 1. GEL COAT, COLOURED.  
LAYER 2. 450GRM/M.SQ GLASS & RESIN  
LAYER 3. 450GRM/M.SQ GLASS & RESIN  
LAYER 4. 450GRM/M.SQ GLASS & RESIN  
  
ALL RESIN TO CLASS II FIRE RETARDANT GRADE.  
ALL REINFORCING BETWEEN LAYERS 3 & 4

PARTS LIST

| ITEM                          | QTY. | COMMENTS               | ITEM                                | QTY. | COMMENTS                    |
|-------------------------------|------|------------------------|-------------------------------------|------|-----------------------------|
| GRP DOUBLE DOOR               | 1    | 2500mm X 1850mm        | TIMBER BATTENS                      |      | ENCAPSULATED IN ROOF        |
| STAINLESS STEEL DOOR HINGES   | 6    | ELEVATION A            | ALU LOUVRED VENTS 1035mm X 616mm    | 4    | ELEVATIONS B, C & D         |
| ST - STEEL ESPAGNOLETTE LATCH | 1    | ELEVATION A            | EXPLOSION RELIEF BRACKETS           | 4    | ELEVATIONS B & D            |
| ST-STEEL SPRING TOWER BOLTS   | 2    | ELEVATION A            | ST - STEEL FIXING FEET              | 7    | DRILLED FOR M10 X 100 BOLTS |
| ST-STEEL DOOR STAYS           | 2    | ELEVATION A            | DANGER OF DEATH DOOR MOULD          | 1    | ELEVATION A (ON DOORS)      |
| REMOVABLE PLINTH BAR          | 1    | ELEVATION A (IN DOORS) | GENERATOR CABLE HATCH 170mm X 170mm | 1    | ELEVATION B                 |
| LIFTING EYES                  | 4    | ELEVATIONS B & D       |                                     |      |                             |



**Envico Engineering**

THE DRAWING AND DESIGN IS THE PROPERTY OF ENVICO ENGINEERING LTD. AND WITHOUT THE WRITTEN CONSENT OF ENVICO ENGINEERING LTD. MAY NOT BE COPIED IN WHOLE OR IN PART OR COMMUNICATED TO A THIRD PARTY OR USED FOR ANY PURPOSE.