

Plan View

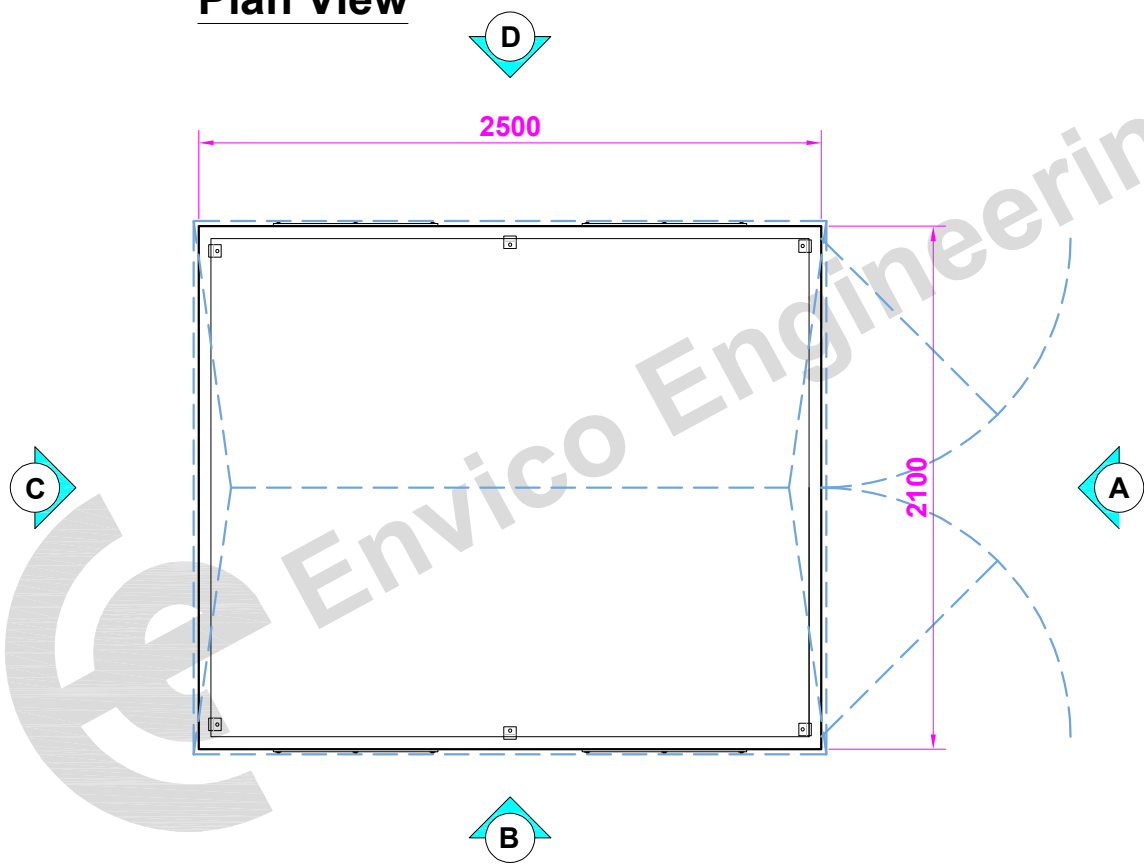

Elevation (A) (front)

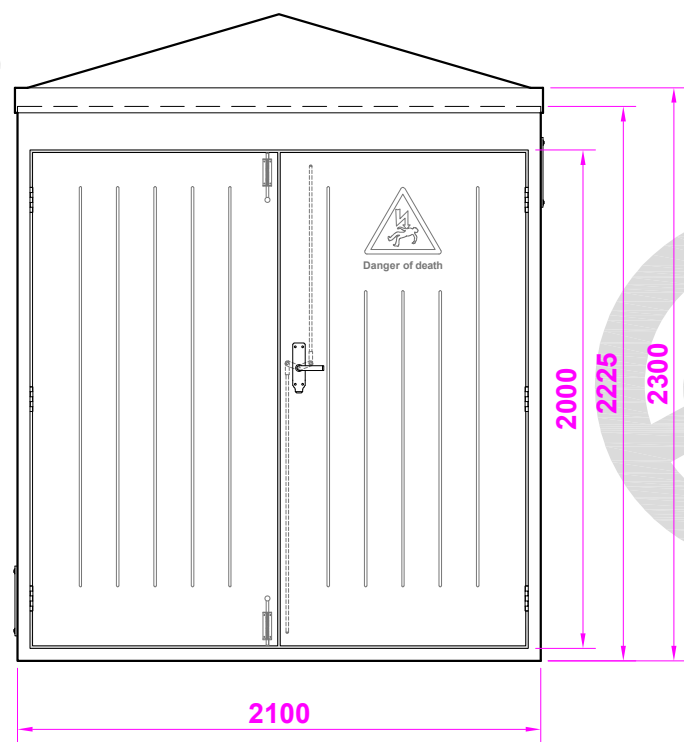

TYPICAL STEPPED BASE DETAIL  
(RECOMMENDED)

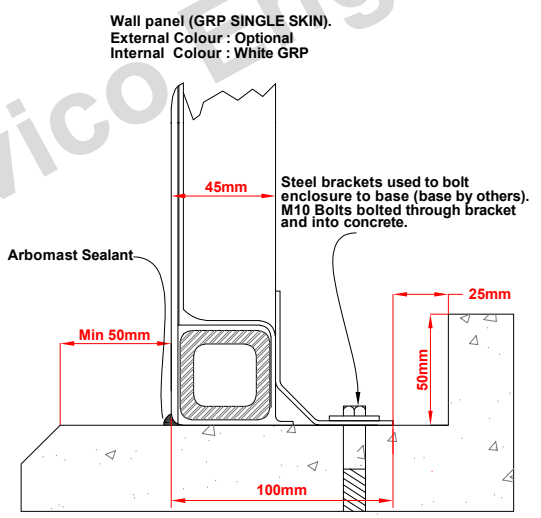

Elevation (B) (l/h side)

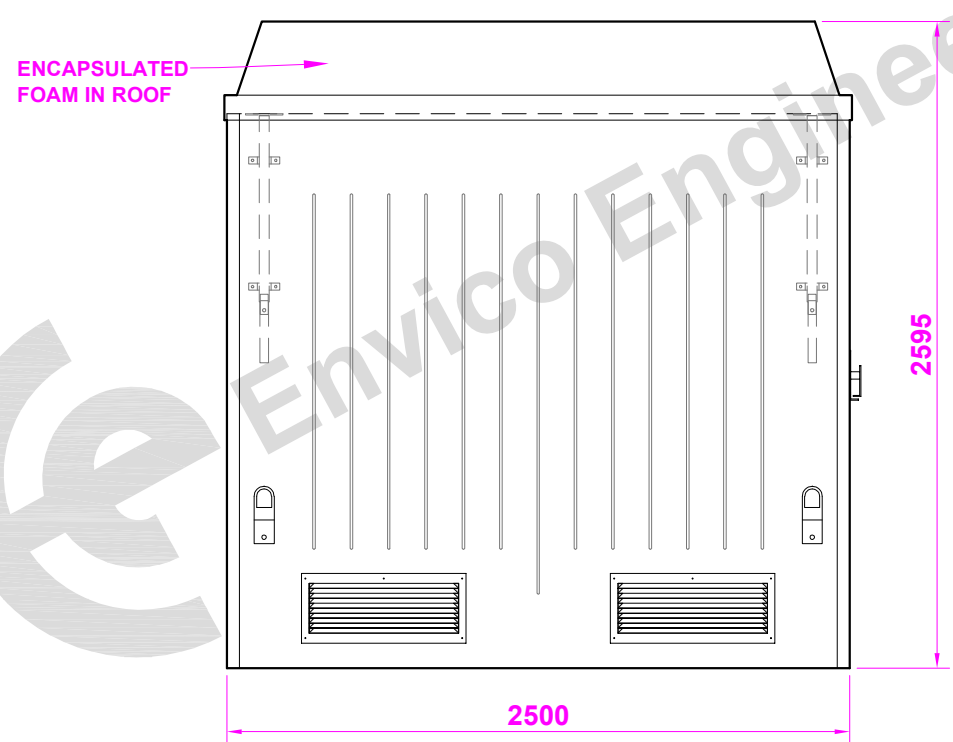

Elevation (C) (rear)

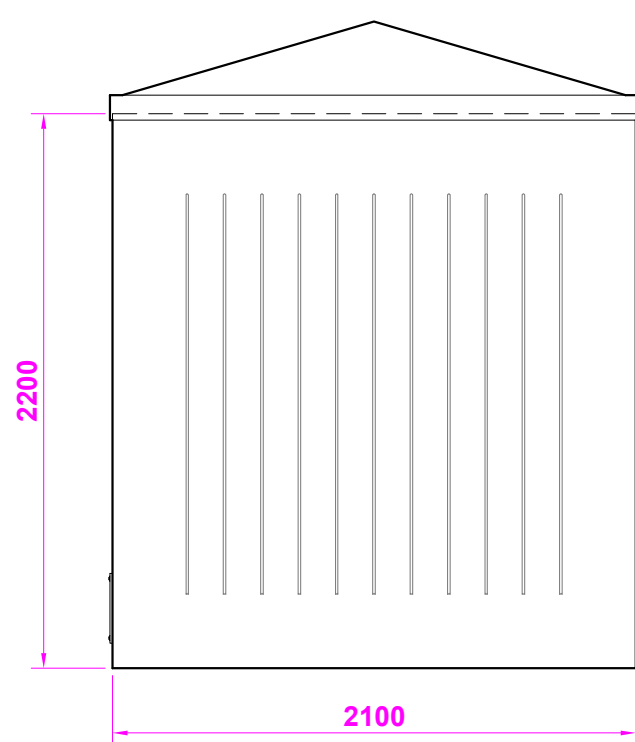

Elevation (D) (r/h side)

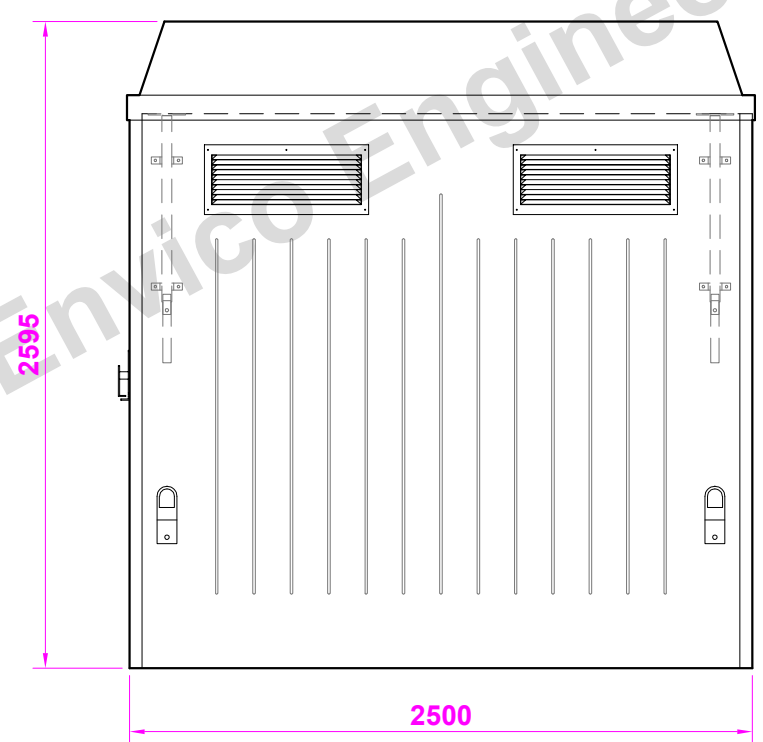

**G.R.P HOUSING  
MODEL TR15**  
APPROX WEIGHT: 425kg

**CONSTRUCTION DETAILS**

INTERNAL WIDTH : 1990mm  
INTERNAL DEPTH : 2390mm  
INTERNAL HEIGHT : 2300mm  
  
EXTERNAL WIDTH : 2100mm  
EXTERNAL DEPTH : 2500mm  
EXTERNAL HEIGHT : 2595mm

**G.R.P CONSTRUCTION**

LAYER 1. GEL COAT, COLOURED.  
LAYER 2. 450GRM/M.SQ GLASS & RESIN  
LAYER 3. 450GRM/M.SQ GLASS & RESIN  
LAYER 4. 450GRM/M.SQ GLASS & RESIN  
  
ALL RESIN TO CLASS II FIRE RETARDANT GRADE.  
ALL REINFORCING BETWEEN LAYERS 3 & 4

**PARTS LIST**

ITEM	QTY.	COMMENTS	ITEM	QTY.	COMMENTS
GRP DOUBLE DOOR	1	ELEVATION A 2000mm X 2000mm	GALV STEEL VENTS	4	ELEVATIONS B & D
STAINLESS STEEL DOOR HINGES	6	ELEVATIONS A (DOORS)	DANGER OF DEATH MOULD	1	ELEVATION A (IN DOORS)
ST - STEEL ESPAGNOLETTE LATCH	1	ELEVATIONS A	EXPLOSION RELIEF BRACKETS	4	ELEVATIONS B & D
ST-STEEL SPRING TOWER BOLTS	2	ELEVATION A	ST - STEEL FIXING FEET	6	DRILLED FOR M10 X 100 BOLTS
10/10 DOOR STAYS	2	ELEVATION A	LIFTING EYES	4	ELEVATIONS B & D



**Envico Engineering**

THE DRAWING AND DESIGN IS THE PROPERTY OF ENVICO ENGINEERING LTD. AND WITHOUT THE WRITTEN CONSENT OF ENVICO ENGINEERING LTD. MAY NOT BE COPIED IN WHOLE OR IN PART OR COMMUNICATED TO A THIRD PARTY OR USED FOR ANY PURPOSE.